

File name: \\N:\server\projects\21843 Georges Fair\Drawings\Sale Plans\Stage 4B\Batch 3\4B Sale Plans 3.dwg Plotted: 10/05/2012 3:27:12 PM Plotted By: Peta Bone

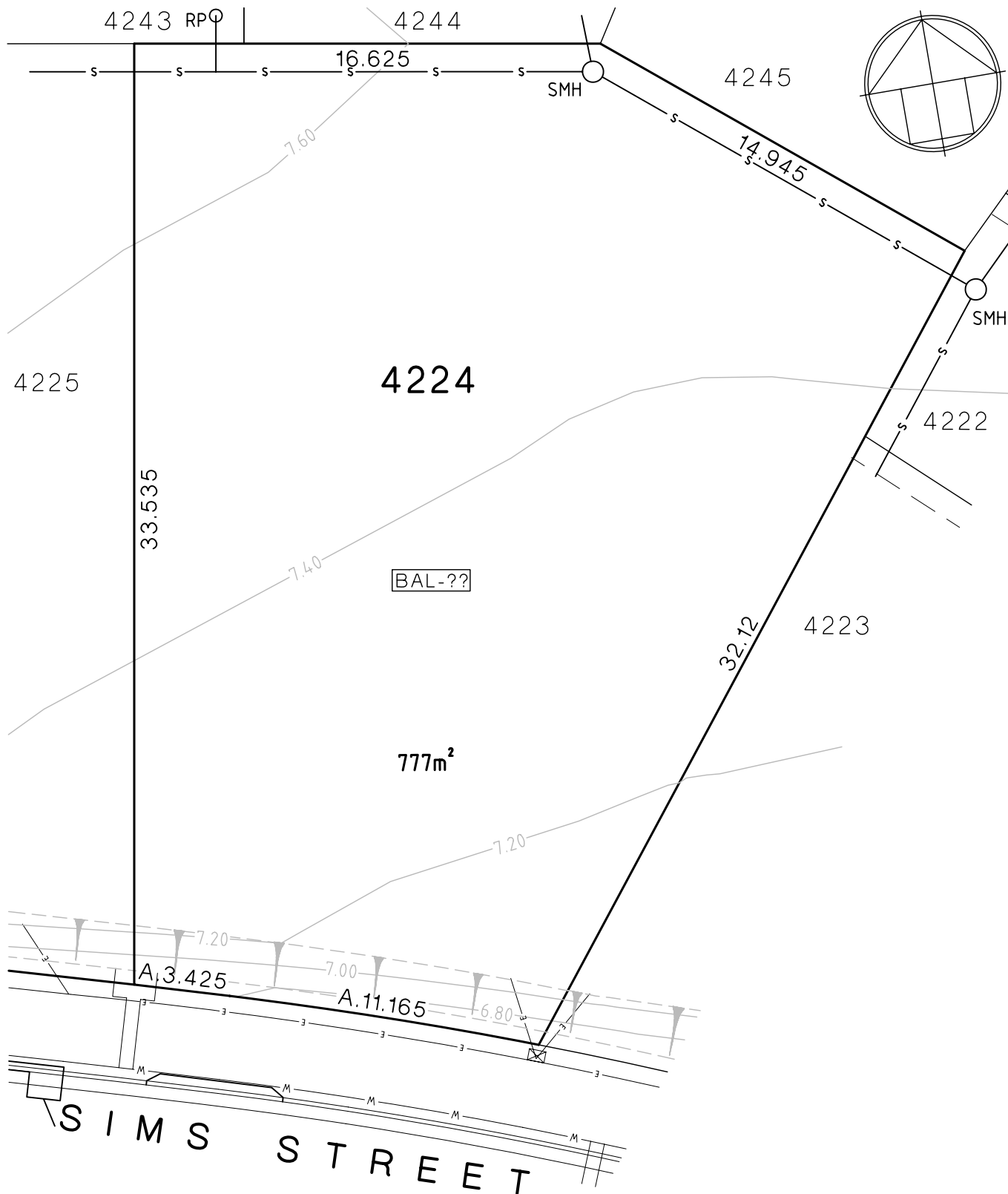

NOTES:-

- 1.) FOR ZERO LOT LINE HOUSING DEVELOPMENT REFER TO GEORGES FAIR - ZERO LOT LINE HOUSE CONSTRUCTION GUIDELINES.
- 2.) CONTOURS ARE BASED ON DESIGN PLAN INFORMATION ONLY AND ARE SUBJECT TO CONSTRUCTION.
- 3.) UTILITY SERVICING PLAN DETAILS ARE BASED ON PRELIMINARY DESIGN INFORMATION. FINAL LOCATION IS SUBJECT TO FINAL DESIGN AND CONSTRUCTION.
- 4.) GAS AND TELECOMMUNICATION MAINS ARE NOT SHOWN.

LEGEND:-

- S— SEWER LINE.
- W— WATERMAIN.
- SW— STORMWATER PIPE.
- E— ELECTRICITY SERVICES.
- 8.2— DESIGN SURFACE CONTOUR.
- BAL BUSHFIRE ASSESSMENT LEVEL.
- SWP STORMWATER PIT.
- SMH SEWER MANHOLE.
- RP SEWER RODDING POINT.

- LIGHT POLE.
- ⊗ ELECTRICITY TURRET.
- DRIVEWAY CROSSING.
- (DVWY) DRIVEWAY ACCESS - NO CROSSING.
- (E) EASEMENT FOR ACCESS, BUILDING, MAINTENANCE & SUPPORT 0.9 WIDE.
- DESIGN BATTER SLOPE.



PRELIMINARY LOT DETAIL PLAN

LOT 4224 DP 1161607
SIMS STREET, GEORGES FAIR

PREPARED BY:
PROUST & GARDNER
 CONSULTING PTY LIMITED
 SURVEYORS & PLANNERS

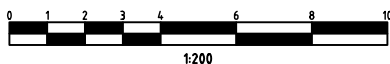

SCALE: 1:200 @ A4 DATE: MAY 2012 PLAN No. 21843/SP4224