

LOT	AREA	LOT	AREA	LOT	AREA
1	3683m <sup>2</sup>	5	3411m <sup>2</sup>	9	1451 ha
2	3518m <sup>2</sup>	6	2171 ha	10	4986m <sup>2</sup>
3	2604m <sup>2</sup>	7	1477 ha	11	7933m <sup>2</sup>
4	3097m <sup>2</sup>	8	1179 ha	12	4001m <sup>2</sup>
				13	9983m <sup>2</sup>
				14	3285 ha

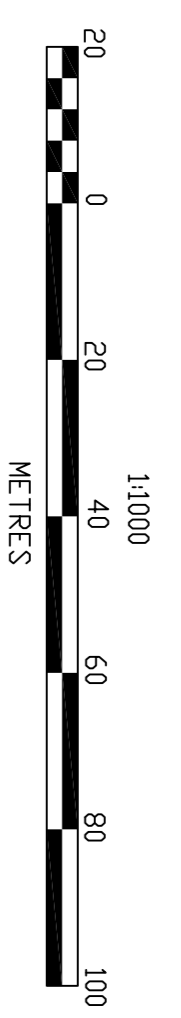

- : ENVIRONMENTAL PROTECTION - NO DEVELOPMENT
- : NO DWELLING OR STORAGE CONSTRUCTION
- : HOME SITE
- : EASEMENT FOR PASSAGE OF STORMWATER (CAN BE GRASSED, GRAVEL OR SEALED)
- : FIRE TRAIL EASEMENTS

NOTES:

1. DATUM OF LEVELS : APPROXIMATE AHD.
2. DEED DIMENSIONS & AREA SHOWN ONLY.
3. SIGNIFICANT TREES LOCATED ONLY.
4. LOCATIONS ARE SUBJECT TO FINAL SURVEY.
5. THE LOCATION OF THE RIGHT OF CARRIAGEWAY FOR EMERGENCY VEHICLES (FIRE TRAIL) IS SUBJECT TO CONFIRMATION BY ENGINEERING DESIGN & FINAL SURVEY. THE PLOTTED POSITION IS DIAGRAMATIC ONLY.

(A) : FIRE TRAIL DENOTES RIGHT OF CARRIAGEWAY FOR EMERGENCY VEHICLES 6 WIDE AND VARIABLE

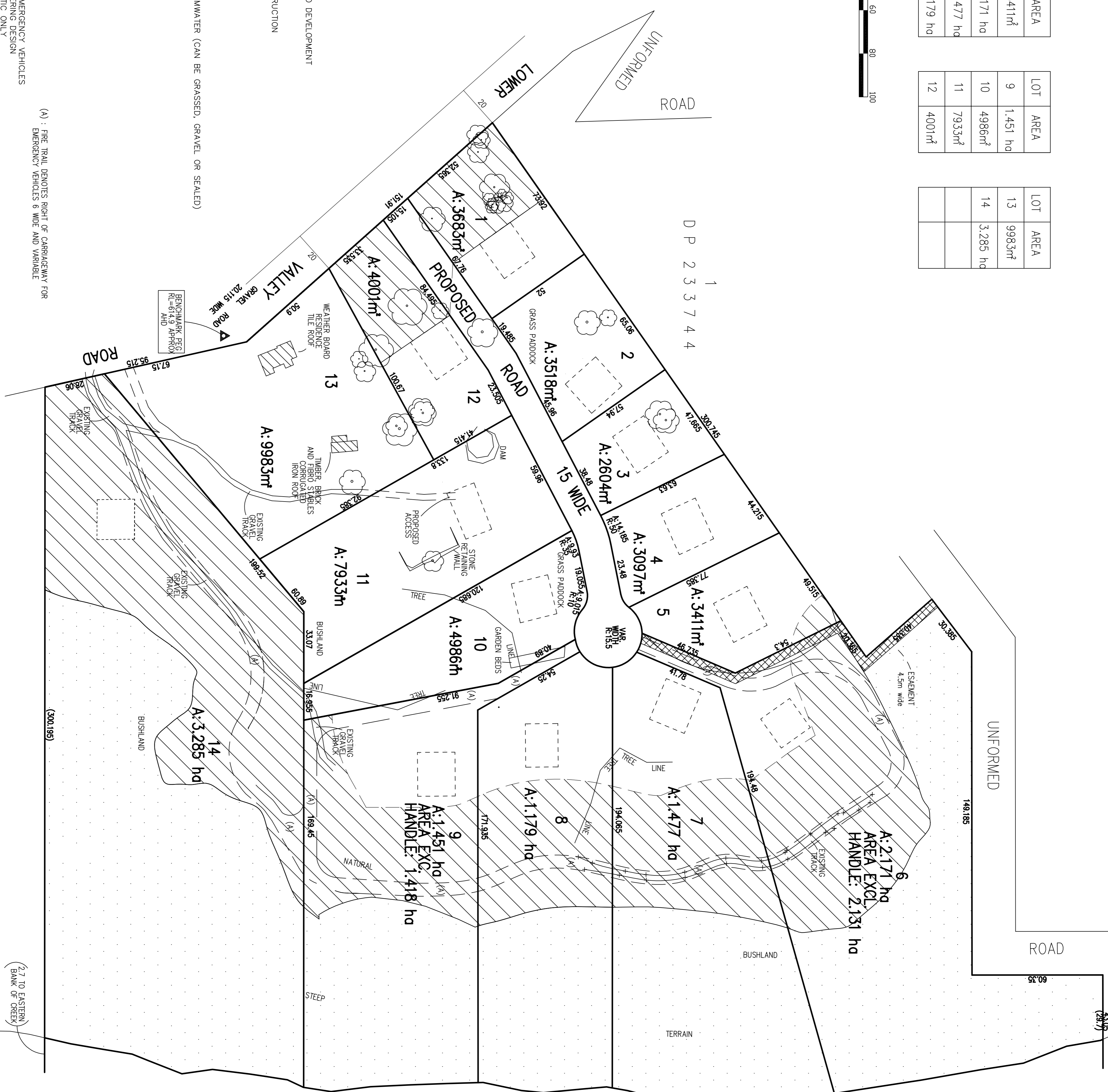

PLAN SHOWING PROPOSED SUBDIVISION OF PART LOT 2 IN DP 233744, No.'s 176-198 LOWER VALLEY ROAD, HAZELBROOK

# HAZELBROOK RURAL ESTATE - PLAN OF SUBDIVISION

REDUCTION RATIO 1:1000 AT A1  
 CONTOUR INTERVAL 10 METERS  
 ORIGIN OF LEVELS APPROXIMATE AUSTRALIAN HEIGHT DATUM