



# Home & Land Package



**Upgrade to  
Modern Façade  
\$462,605**

## Dandelion 20 Traditional Facade

**Call 4648 1475  
for more  
information**

# \$458,805

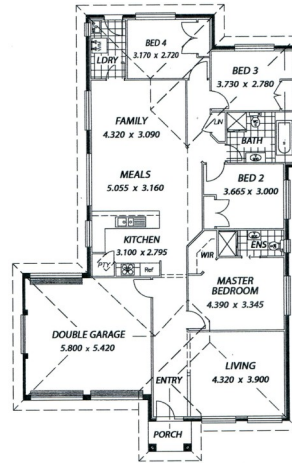

# LILY HOMES

The Dandelion is designed with the first home buyer or those wishing to downsize in mind.

Featuring four bedrooms or three plus study and with a drive through garage for the trailer, boat or easy access to the backyard.

### PRICE INCLUDES:

**550m<sup>2</sup> Block / House / Site Costs  
Basix & Lily Quality Inclusions**

- Plus:** Carpet to bedrooms and lounge.
- Ceramic tiling to porch, entry, hall, kitchen, meals, family.
- Vertical blinds. Flyscreens to opening windows.
- Stencilcrete driveway (up to 54m<sup>2</sup>). Clothes line.
- Turfing. Letterbox. BAL 12.5 Fire Rating.

**Upgrade to** ducted air conditioning, polyurethane kitchen doors and stone bench top: **TOTAL \$476,105** NB Other Facades Available  
*Subject to survey, site assessment, estate requirements, council requirements, design guidelines etc.*

*comfort,  
design,  
affordability*

**Need something different?  
We build your plans, our plans or we'll design together. For more  
information simply ask or call Ken on 02 4648 1745 or 0401 468 246**

